

Saturday, April 24, 925 Yds.

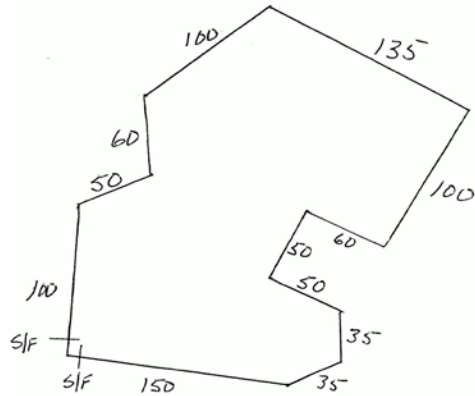

925 yds

Sunday, April 25, 865 Yds

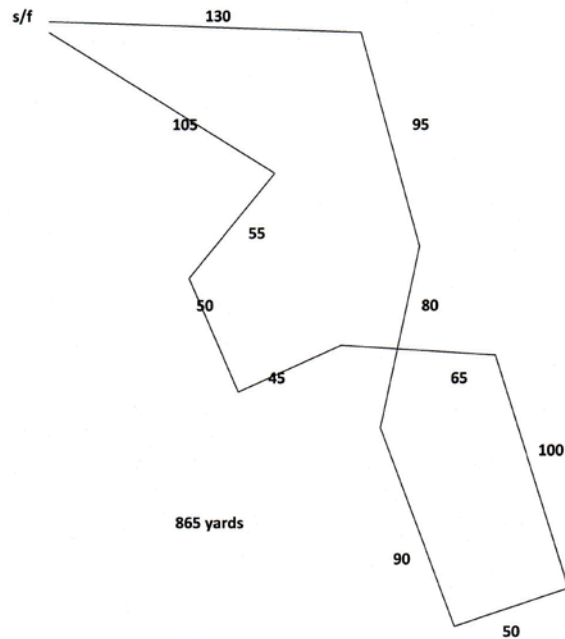

## HEARTLAND COURSING ASSOCIATION PREMIUM LIST

Early Entries close Wednesday, April 21, 2010, at the FTS's House.  
Day of Trial Entries close 30 minutes before Roll Call, at the FTS Tent.

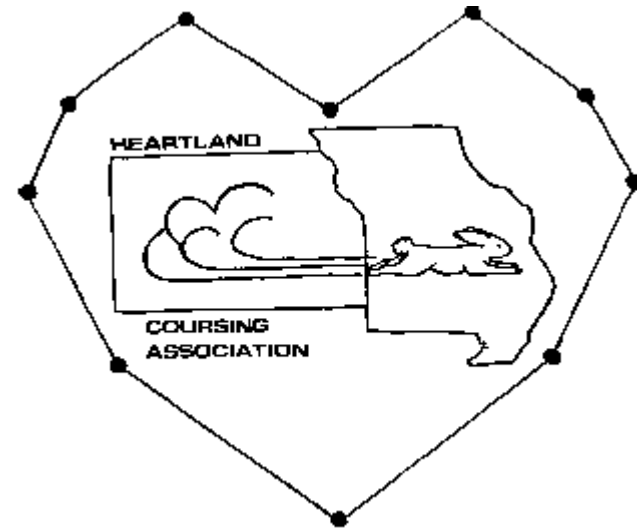

### REGION 5

ASFA Sanctioned All Breed Lure Field Trial  
April 24 & April 25, 2010

CLINTON STATE PARK

798 N. 1415 Road

LAWRENCE, KANSAS 66049

By courtesy of the KS Department of Wildlife & Parks

### EARLY ENTRY FEE:

\$15 for 1<sup>st</sup> Hound, \$12 for 2<sup>nd</sup> Hound,  
\$10 for 3<sup>rd</sup> or More Entered Hounds – Same Household  
**DAY OF TRIAL ENTRY FEE: \$25 per Hound**

HCA reserves the right to alter the course as required by weather and/or field conditions on the day of the trial. The course will be reversed for finals and again for run-offs or at the discretion of the judges.

Permission has been granted by the American Sighthound Field Association for the holding of this event under ASFA Rules & Regulations  
Denise Como, Chairman, ASFA Scheduling Committee

## HCA OFFICERS

President – Randy Cantrell, Vice-President – Scott Hurlbert,  
Secretary – Russ Jacobs, Treasurer – Carol McDermott,  
Board – Stephanie Cantrell, Julie Hurlbert, Vickie Jacobs, Rita Koerner, Merry Titus

## JUDGES & ASSIGNMENTS (Running Order will be Posted at Trial)

Dawn Ferris, Lexington, OH  
Mike Ferris, Chesterfield, MO  
Scott Hurlbert, Kansas City, KS

### Sat 4/24

A – DF, MF  
AZ – DF, MF  
BA – DF, MF  
B – DF, SH  
C – DF, MF  
GH – DF, SH  
IB – DF, MF  
IW – DF, MF  
IG – DF, MF  
PH – DF, MF  
RR – DF, SH  
S – DF, SH  
SD – DF, MF  
SL – DF, MF  
W – DF, MF  
LMT – DF, SH  
SNG – DF, SH

### Sun 4/25

A – DF, MF  
AZ – DF, MF  
BA – MF, SH  
B – MF, SH  
C – MF, MF  
GH – MF, SH  
IB – DF, MF  
IW – DF, MF  
IG – DF, MF  
PH – DF, MF  
RR – DF, MF  
S – DF, MF  
SD – DF, MF  
SL – DF, MF  
W – DF, SH  
LMT – MF, SH  
SNG – MF, SH

## TRIAL COMMITTEE

Trial Chairman – Scott Hurlbert, 913.907.5361, [dwhippet@hotmail.com](mailto:dwhippet@hotmail.com)  
Trial Secretary – Julie Hurlbert, 913.768.0459, [dboyz@sbcglobal.net](mailto:dboyz@sbcglobal.net)

### **Day of Trail – Julie's Cell – 913.221.6684**

Lure Operators – Randy Cantrell, Scott Hurlbert, Russ Jacobs, Mike Ferris

## RIBBONS & TROPHIES

Ribbons will be awarded for all placements 1<sup>st</sup> through NBQ. Rosette will be awarded for Best of Breed.  
Trophies will be awarded by club & member donations.

## TRIAL INFORMATION

Trial Hours – **8:00 am** until completion.

Roll Call – **9:00 am** – No Exceptions or Excuses.

There will be a verbal roll call, if you are NOT PRESENT before the conclusion of roll call, you will be considered ABSENT AT ROLL CALL!

Entry Fee will not be refunded. Entries will not be acknowledged by mail.

## ELIGIBILITY REQUIREMENTS

Only purebred Afghan Hounds, Azawakhs, Basenjis, Borzoi, Cirneco dell'Etna, Greyhounds, Ibizan Hounds, Irish Wolfhounds, Italian Greyhounds, Pharaoh Hounds, Rhodesian Ridgebacks, Salukis, Scottish Deerhounds, Sloughis, Whippets, and Provisional Breeds, if any, may be entered in the regular stakes. Limited Stake Breeds, if any, may be entered in the Limited Stake. Limited breeds currently include purebred Chart Polskis, Galgo Espanol, Magyar Agars, Peruvian Inca Orchids, Portuguese Podengos, and Silken Windhounds. All entries in the regular stakes shall be individually registered with the AKC, UKC, NGA, the FCI an ASFA-recognized foreign registry or ASFA board approved registry, or possess a CRN from the SDBDS. Indefinite Listing Privilege (ILP) or a Purebred Alternate Listing (PAL) from the AKC shall be considered registered with that body. Limited and/or Provisional Stake entries shall be individually registered with the appropriate registry. A photocopy of acceptable registry must be submitted with a hound's first ASFA field trial entry, this requirement is waived for hounds registered with the NGA.

## STAKES OFFERED

**Open:** Any eligible sighthound that has met certification requirements, excluding ASFA Field Champions of record.

**Field Champion:** Any ASFA Field Champion.

**Veteran:** Any eligible sighthound that has met certification requirements whose age is at least six years, **except** Irish Wolfhounds whose age shall be at least five years, Rhodesian Ridgebacks and Whippets whose age shall be at least seven years.

**Singles:** Any eligible sighthound including those disqualified to run in other stakes. Not eligible for Best of Breed.

**Limited:** Any eligible sighthound of a Limited or Provisional stake breed that has met certification requirements. Not eligible for Best of Breed.

**Best in Field will not be offered either day.**

**Hound certification runs & practices will be offered on Saturday only, time, weather and equipment permitting**

- All entries must be one year of age or older on the day of the trial.
- Stakes will be split if 20 or more hounds of the same breed are present, in any one stake, **after** inspection at the time of the draw.
- All hounds will run twice, in trios if possible, or braces (except the Single Stake), unless excused, dismissed or disqualified.
- Bitches in season, lame hounds, or hounds with breed disqualifications will be excused at roll call.
- Each hound will be inspected for lameness, breed disqualifications, and bitches in season.
- Monorchid, spayed and neutered hounds without breed disqualifications may be entered, hounds with breed disqualifications are only eligible to enter in the Single Stake.
- Hounds not present at time of roll call will be scratched.
- Hound certification runs will be offered after the completion of ribbons on Saturday, with equipment and weather permitting.
- Muzzles are not required, but it is the responsibility of the owner to determine if the hound should be muzzled.
- Dogs may not be tied or staked out. There will be a **\$5** penalty fee for any hound loose on the field, other than those running the course in progress.
- Lure coursing blankets may be provided by the club.
- A battery powered continuous loop machine will be used. Backup equipment is available.
- The Lure will consist of white plastic bags.
- There are available water, shade & restroom facilities at the site.
- Incomplete, unsigned, conditional, or late entries **WILL NOT** be accepted.

**\*\*THERE WILL BE A \$25 RETURN CHECK CHARGE\*\***

**OFFICIAL AMERICAN SIGHTHOUND FIELD ASSOCIATION**  
**ENTRY FORM**  
**HEARTLAND COURSING ASSOCIATION**  
**SATURDAY, APRIL 24, 2010**

Julie Hurlbert, 1410 N. Martway Dr., Olathe, KS 66061, 913.768.0459  
 Early Entries close **Wed., April 21.** \$15 for 1<sup>st</sup>, \$12 for 2<sup>nd</sup>, \$10 for 3 or  
 more. Day of Trail Entries close 30 minutes before Roll Call.

Day of Trial Entry Fee **\$25 PER Hound.**

Fee Paid \_\_\_\_\_ The Field Secretary cannot accept conditional, unsigned, incomplete or unpaid entries; please check your completed entry carefully.

Breed:		Call Name:	
Registered Name of Hound:			
Stake: <input type="checkbox"/> Open <input type="checkbox"/> FCH <input type="checkbox"/> Veteran <input type="checkbox"/> Single <input type="checkbox"/> Limited		Additional Stakes: <input type="checkbox"/> Kennel <input type="checkbox"/> Breeder	
Registration Number: (circle one) AKC Reg. # AKC ILP/PAL: NGA #: Critique Reg #: Foreign Reg. # & Country: Pending: UKC Reg. #			
<input type="checkbox"/> If possible, please separate my hounds	Date of Birth:	Sex: <input type="checkbox"/> Dog <input type="checkbox"/> Bitch	
Name of actual owner(s):			
Address:		Phone:	
City:	State:	Zip:	
E-mail (Optional)		(Optional) Region of Residence:	
<input type="checkbox"/> Check if this is the first ASFA trial for this hound. Attach a Hound Certification or waiver if entered in Open, Veterans, Limited. <input type="checkbox"/> Check if this is a first-time entry, a copy of the official Registration of this hound must accompany this entry unless NGA.			
<input type="checkbox"/> Check if any information has changed since the last ASFA trial entry. Regarding _____			
<input type="checkbox"/> Check if this hound has been dismissed within the last 6 trials entered. Must be marked in order to qualify for a "clean" trial requirement.			

I CERTIFY that I am the actual owner of this dog, or that I am the duly authorized agent of the actual owner whose name I have entered above. In consideration of the acceptance of this entry and the opportunity to have this dog judged and to win prize money, ribbons, or trophies, I (we) agree to abide by the rules and regulations of the American Sighthound Field Association in effect at the time of this lure field trial, and by any additional rules and regulations appearing in the premium list for this lure field trial. I (we) agree that the club holding this lure field trial has the right to refuse this entry for cause, which the club shall deem to be sufficient. I (we) agree to hold this club, its members, directors, governors, officers, agents or other functionaries, any employees of the aforementioned parties and the owner(s) of the trial premises or grounds harmless from any claim for loss or injury which may be alleged to have been caused directly or indirectly to any person or thing by the act of this dog while in or upon the lure field trial premises or grounds or near any entrance thereto and I (we) personally assume all responsibility and liability for any such claim, and I (we) further agree to hold the aforementioned parties harmless from any claim loss of this dog by disappearance, theft damage or injury be caused or alleged to be caused by the negligence of the club or any of the aforementioned parties or by the negligence of any person or any other cause or causes. I (we) certify and represent that the dog entered is not a hazard to person or other dogs. This entry is submitted for acceptance of the forgoing representations and agreements

**SIGNATURE** of owner or his agent  
 duly authorized to make this entry \_\_\_\_\_

**OFFICIAL AMERICAN SIGHTHOUND FIELD ASSOCIATION**  
**ENTRY FORM**  
**HEARTLAND COURSING ASSOCIATION**  
**SUNDAY, APRIL 25, 2010**

Julie Hurlbert, 1410 N. Martway Dr., Olathe, KS 66061, 913.768.0459  
 Early Entries close **Wed., April 21.** \$15 for 1<sup>st</sup>, \$12 for 2<sup>nd</sup>, \$10 for 3 or  
 more. Day of Trail Entries close 30 minutes before Roll Call.

Day of Trial Entry Fee **\$25 PER Hound.**

Fee Paid \_\_\_\_\_ The Field Secretary cannot accept conditional, unsigned, incomplete or unpaid entries; please check your completed entry carefully.

Breed:		Call Name:	
Registered Name of Hound:			
Stake: <input type="checkbox"/> Open <input type="checkbox"/> FCH <input type="checkbox"/> Veteran <input type="checkbox"/> Single <input type="checkbox"/> Limited		Additional Stakes: <input type="checkbox"/> Kennel <input type="checkbox"/> Breeder	
Registration Number: (circle one) AKC Reg. # AKC ILP/PAL: NGA #: Critique Reg #: Foreign Reg. # & Country: Pending: UKC Reg. #			
<input type="checkbox"/> If possible, please separate my hounds	Date of Birth:	Sex: <input type="checkbox"/> Dog <input type="checkbox"/> Bitch	
Name of actual owner(s):			
Address:		Phone:	
City:	State:	Zip:	
E-mail (Optional)		(Optional) Region of Residence:	
<input type="checkbox"/> Check if this is the first ASFA trial for this hound. Attach a Hound Certification or waiver if entered in Open, Veterans, Limited. <input type="checkbox"/> Check if this is a first-time entry, a copy of the official Registration of this hound must accompany this entry unless NGA.			
<input type="checkbox"/> Check if any information has changed since the last ASFA trial entry. Regarding _____			
<input type="checkbox"/> Check if this hound has been dismissed within the last 6 trials entered. Must be marked in order to qualify for a "clean" trial requirement.			

I CERTIFY that I am the actual owner of this dog, or that I am the duly authorized agent of the actual owner whose name I have entered above. In consideration of the acceptance of this entry and the opportunity to have this dog judged and to win prize money, ribbons, or trophies, I (we) agree to abide by the rules and regulations of the American Sighthound Field Association in effect at the time of this lure field trial, and by any additional rules and regulations appearing in the premium list for this lure field trial. I (we) agree that the club holding this lure field trial has the right to refuse this entry for cause, which the club shall deem to be sufficient. I (we) agree to hold this club, its members, directors, governors, officers, agents or other functionaries, any employees of the aforementioned parties and the owner(s) of the trial premises or grounds harmless from any claim for loss or injury which may be alleged to have been caused directly or indirectly to any person or thing by the act of this dog while in or upon the lure field trial premises or grounds or near any entrance thereto and I (we) personally assume all responsibility and liability for any such claim, and I (we) further agree to hold the aforementioned parties harmless from any claim loss of this dog by disappearance, theft damage or injury be caused or alleged to be caused by the negligence of the club or any of the aforementioned parties or by the negligence of any person or any other cause or causes. I (we) certify and represent that the dog entered is not a hazard to person or other dogs. This entry is submitted for acceptance of the forgoing representations and agreements

**SIGNATURE** of owner or his agent  
 duly authorized to make this entry \_\_\_\_\_

**AMERICAN SIGHTHOUND FIELD ASSOCIATION  
HOUND CERTIFICATION**

**Rule effective October 1, 1994: Ch. V, Sec. 4 (a) OPEN STAKE:** *To be eligible to enter the open stake, a hound must have been certified by a licensed judge within the year preceding the closing date for the entry or have previously competed in the Open Stake.* This eligibility requirement also applies to a hound entered in the Limited or Veteran Stake, which has not competed in Open previously. Please complete this portion of this form and attach it to the entry form for the hound's first entry, including an entry for a Fun Trial.

Registered Name of Hound: \_\_\_\_\_  
Registration Number: \_\_\_\_\_ Breed: \_\_\_\_\_  
Registered Owner's Name: \_\_\_\_\_

I hereby certify that on (date) \_\_\_\_\_, the above named hound completed a lure course of at least 500 yards, running with another hound of the same breed (or another breed with a similar running style). During the course the above named hound showed no inclination to interfere with the other hound. I further certify that I am a licensed judge for the ASFA.

Name of Licensed Judge: \_\_\_\_\_  
Signature: \_\_\_\_\_ Date: \_\_\_\_\_

I hereby certify that the hound running in the certification course is the hound identified above and that information provided on this form is true and correct.

Signature: \_\_\_\_\_ Date: \_\_\_\_\_

Owner or Authorized Agent of Hound

This certification form must be attached to the entry form the first time this hound is entered in an open, limited, or veteran stake. Any hound entered in open, limited, or veteran (as a first time entered hound), which has not been certified, shall be declared ineligible by the records coordinator and shall forfeit any points and placements awarded.

**PLEASE RETAIN A COPY FOR YOUR RECORDS.**

**AMERICAN SIGHTHOUND FIELD ASSOCIATION  
HOUND CERTIFICATION WAIVER**

**Waiver of Requirement:** *This requirement will be waived for a hound that has earned a lure coursing or racing title from another recognized organization, if such title requires competition, and if a waiver for such title has been approved by the ASFA, or a CKC Hound Certification Form.* If your hound qualifies for a waiver, complete this portion of this form and attach it to your entry form. Proof of waivers must accompany this certification form.

Registered Name of Hound: \_\_\_\_\_  
Registration Number: \_\_\_\_\_ Breed: \_\_\_\_\_  
Registered Owner's Name: \_\_\_\_\_

**CKC:** FCH FCHX **CWA:** ARX TRP SRA DPC  
**AKC:** FC SC **LGRA:** GRC **NAWRA:** RCH SR  
**WRA:** CR WRCH **NOTRA:** ORC OTR SORC SOR

Hound Certification previously submitted.

I hereby certify that the hound identified above has completed the requirements for the title indicated above (or that the required Certification was previously submitted) and that the information provided on this form is true and correct.

Signature: \_\_\_\_\_ Date: \_\_\_\_\_

Owner or Authorized Agent of Hound

**AMERICAN SIGHTHOUND FIELD ASSOCIATION  
HOUND CERTIFICATION**

**Rule effective October 1, 1994: Ch. V, Sec. 4 (a) OPEN STAKE:** *To be eligible to enter the open stake, a hound must have been certified by a licensed judge within the year preceding the closing date for the entry or have previously competed in the Open Stake.* This eligibility requirement also applies to a hound entered in the Limited or Veteran Stake, which has not competed in Open previously. Please complete this portion of this form and attach it to the entry form for the hound's first entry, including an entry for a Fun Trial.

Registered Name of Hound: \_\_\_\_\_  
Registration Number: \_\_\_\_\_ Breed: \_\_\_\_\_  
Registered Owner's Name: \_\_\_\_\_

I hereby certify that on (date) \_\_\_\_\_, the above named hound completed a lure course of at least 500 yards, running with another hound of the same breed (or another breed with a similar running style). During the course the above named hound showed no inclination to interfere with the other hound. I further certify that I am a licensed judge for the ASFA.

Name of Licensed Judge: \_\_\_\_\_  
Signature: \_\_\_\_\_ Date: \_\_\_\_\_

I hereby certify that the hound running in the certification course is the hound identified above and that information provided on this form is true and correct.

Signature: \_\_\_\_\_ Date: \_\_\_\_\_

Owner or Authorized Agent of Hound

This certification form must be attached to the entry form the first time this hound is entered in an open, limited, or veteran stake. Any hound entered in open, limited, or veteran (as a first time entered hound), which has not been certified, shall be declared ineligible by the records coordinator and shall forfeit any points and placements awarded.

**PLEASE RETAIN A COPY FOR YOUR RECORDS.**

**AMERICAN SIGHTHOUND FIELD ASSOCIATION  
HOUND CERTIFICATION WAIVER**

**Waiver of Requirement:** *This requirement will be waived for a hound that has earned a lure coursing or racing title from another recognized organization, if such title requires competition, and if a waiver for such title has been approved by the ASFA, or a CKC Hound Certification Form.* If your hound qualifies for a waiver, complete this portion of this form and attach it to your entry form. Proof of waivers must accompany this certification form.

Registered Name of Hound: \_\_\_\_\_  
Registration Number: \_\_\_\_\_ Breed: \_\_\_\_\_  
Registered Owner's Name: \_\_\_\_\_

**CKC:** FCH FCHX **CWA:** ARX TRP SRA DPC  
**AKC:** FC SC **LGRA:** GRC **NAWRA:** RCH SR  
**WRA:** CR WRCH **NOTRA:** ORC OTR SORC SOR

Hound Certification previously submitted.

I hereby certify that the hound identified above has completed the requirements for the title indicated above (or that the required Certification was previously submitted) and that the information provided on this form is true and correct.

Signature: \_\_\_\_\_ Date: \_\_\_\_\_

Owner or Authorized Agent of Hound

## Things you might want to know...

Breakfast and Lunch will be available both days for a small fee.

There will be a Judges Dinner Saturday Night - Details at the trial.

Don't forget, we will have HCA T-Shirts, Sweatshirts, Ball Caps, and Lapel Pins for sale.

Practices and Certifications will be ran after the trial on Saturday, time & weather permitting.

For Emergency Vet Service, Trial Committee will have phone number and directions at the FTS Tent.

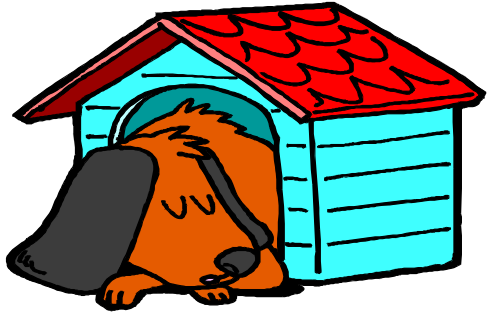

### Places to rest you & your dogs...

Econolodge (Olathe or Lawrence)	800.984.4878
Travel Lodge, Lawrence	800-578-7878
Holiday Inn Express, Lawrence	785.841.7077
Best Western, Lawrence	785.843.1572
Bismark Inn, Lawrence	785.749.4040
Best Western, Topeka	785.267.1681
Super 8, Desota	913.583.3880
RV/Tent Camping, Clinton State Park	785-842-8562
or contact Vickie Jacobs, 785-379-5430 or zzjaco@aol.com	

**\*\* Please double check their pet policies \*\***

**\*\* This is a college & race town, make reservations EARLY**

Check out Heartland Coursing on the Web...  
[www.heartlandcoursing.com](http://www.heartlandcoursing.com)

Check out ASFA on the Web...  
[www.asfa.org](http://www.asfa.org)



### **\*\*\* IMPORTANT NOTICE \*\*\***

At this time, we do not know from the park if we will be at the Shelter House Fields or the Beach Fields, Due to the conditions of the fields.

### **PLEASE PLEASE PLEASE**

Provide me with your email on your entry forms and I will email you the exact fields we will be on - unfortunately we will not know for sure until April 12<sup>th</sup>.

### **QUESTIONS**

If you are gate entering, or need help, or have questions, call me the day of the trial...

**913.221.6684**

**Julie**



### DIRECTIONS TO THE FIELD

**From the Kansas City Area** - I-35 to I-435 West to Highway 10 to Lawrence. Hwy 10 will become 23<sup>rd</sup> Street on the East Side of Lawrence. Stay on this through Lawrence. 23<sup>rd</sup> Street will become Clinton Parkway on the West Side of Lawrence. Stay on Clinton Parkway until it dead-ends. Turn Right. Stay on this road to Clinton State Park entrance - 2<sup>nd</sup> left. Turn left into park, it's before the gas station.

**For I-70 Drivers,** - Take I-70 (East from Topeka, West from Kansas City), exit at Lecompton, turn South, this is Highway 10. Take this to the Clinton Parkway Exit, at the stop sign, turn right. At the next stop sign, turn right again, then take your 2<sup>nd</sup> left into Clinton State Park.

Once in the park, go through the Permit Station, have your \$\$\$ ready, (you only need to buy a 1 day pass, as they are good till 2 pm the following day), then get back on the main park road and "follow the yellow signs".

This is a State Park. They require permits. If you have a permit from any other State Park, you might be able to get a discount - be sure to check!

**Please be sure to pick up after your dog and you!!**

### Alternate course plans if we have to move to the smaller fields

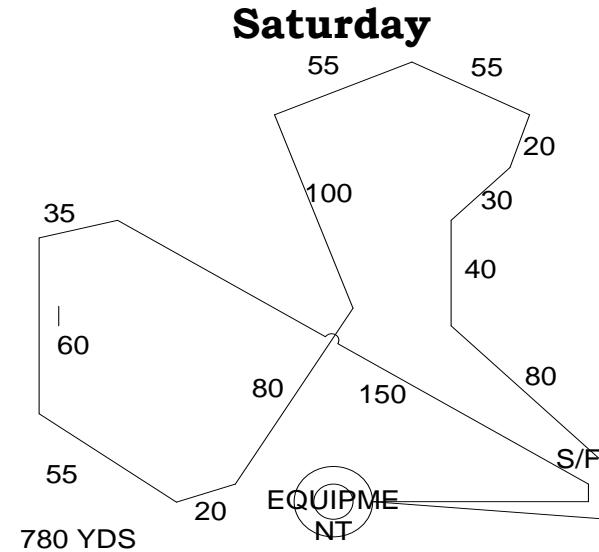

### Sunday

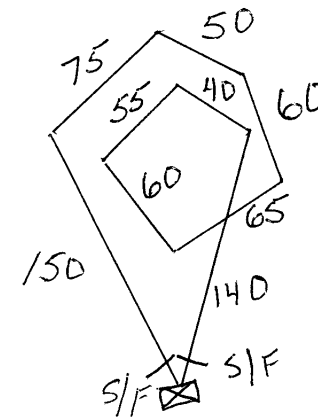

695 yds